



ACCESSORIES



【PSA】

※SPECIFICATION

MODEL	PRES. ADJ. RANGE (Bar)	SURGE PRES. (Bar)	WEIGHT (Kg)
PSA-50K	6~50	200	0.8
PSA-100K	15~100	300	
PSA-200K	30~200	300	
PSA-280K	40~280	350	
PSA-400K	50~400	450	



※MODEL NUMBER DESIGNATION

PSA	280K	21B
Series No. Direct read-out, DC 24V Transistor Sensing Switch	Pres. Adj. Range (Bar) 50K: 6~50 100K: 15~100 200K: 30~200 280K: 40~280 400K: 50~400	Design No: 21B: 1/4" PT 21B80: 1/4" PF(G) 21B90: 1/4" NPT

※DIMENSION

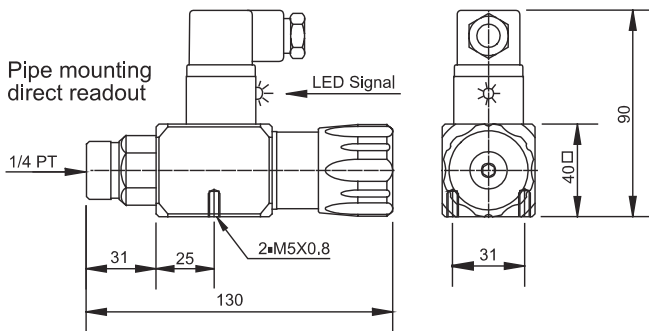

UNIT: M.M.

※WIRING DIAGRAM

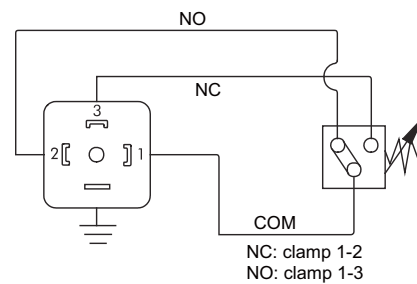

Breaking Capacity	Voltage Up To	Resistance Load
D.C.	24V	<100 mA
Electrically: 80,000,000 Times		

※PERFORMANCE CURVE

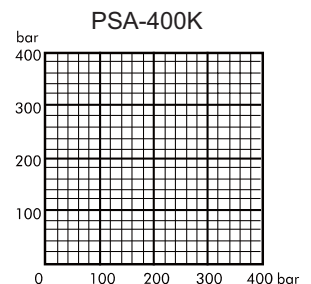
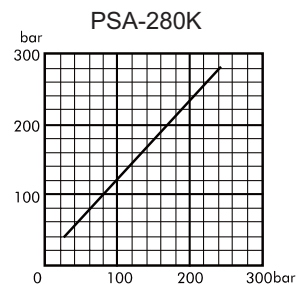
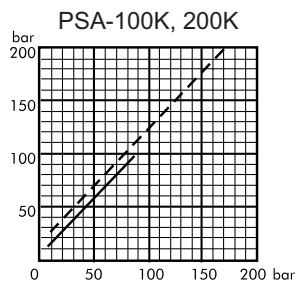
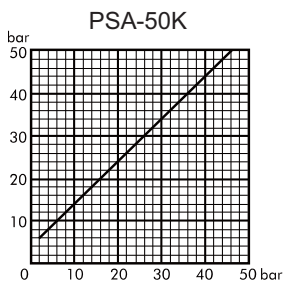

※SCHEMATIC CROSS-SECTION

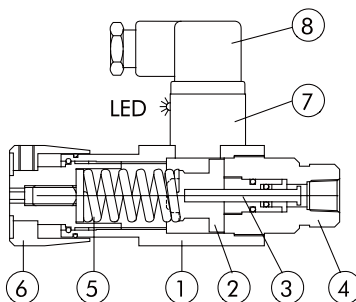

1	Body(Aluminum Alloy)	5	Spring
2	Switch Sensing Seat	6	Pressure Adj. Knob
3	Servo Piston	7	Induction-Switch
4	Connection Part	8	Wiring Connector



SOLTECH

ACCESSORIES

PRESSURE SWITCHES-NPN

[PSB]

※SPECIFICATION

MODEL	PRES. ADJ. RANGE (Bar)	SURGE PRES. (Bar)	WEIGHT (Kg)
PSB-40K	5~40	150	0.4
PSB-70K	6~70	200	
PSB-150K	30~150	300	
PSB-250K	40~250	300	

※MODEL NUMBER DESIGNATION

PSB	250K	21B
Series No.	Pres. Adj. Range (Bar)	Design No:
General Type	40K: 5~40	21B: 1/4" PT
Direct read-out, DC 24V	70K: 6~70	21B80: 1/4" PF(G)
Transistor Sensing Switch	150K: 30~150	21B90: 1/4" NPT
	250K: 40~250	



H

※DIMENSION

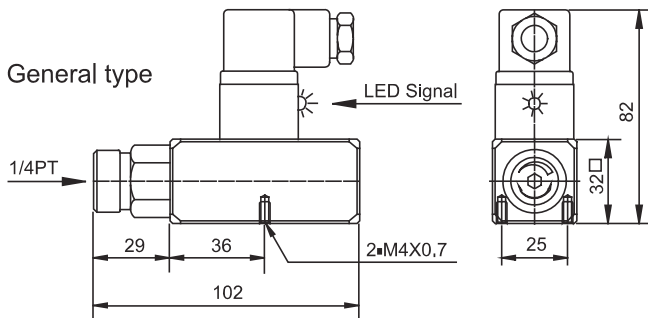

※WIRING DIAGRAM

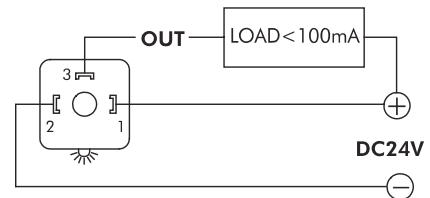

Breaking Capacity	Voltage Up To	Resistance Load
D.C.	24V	<math>< 100\text{ mA}</math>
Electrically: 80,000,000 Times		

UNIT: M.M.

※PERFORMANCE CURVE

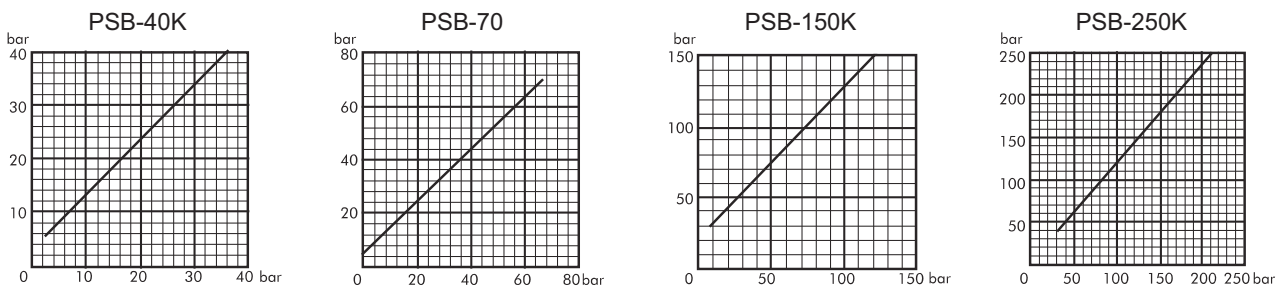

※SCHEMATIC CROSS-SECTION

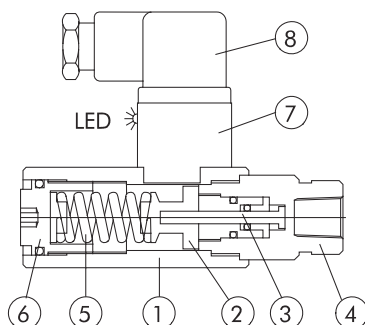

1	Body(Aluminum Alloy)	5	Spring
2	Switch Sensing Seat	6	Pressure Adj. Knob
3	Servo Piston	7	Induction-Switch
4	Connection Part	8	Wiring Connector

【PSL】

※SPECIFICATION

MODEL	PRES. ADJ. RANGE (Bar)	SURGE PRES. (Bar)	WEIGHT (Kg)
PSL-50K	6~50	200	0.8
PSL-100K	15~100	300	
PSL-200K	30~200	300	
PSL-280K	40~280	350	
PSL-400K	50~400	450	

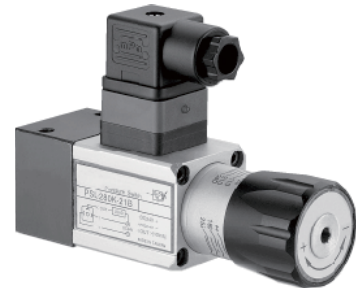

※MODEL NUMBER DESIGNATION

PSL	280K	21B
Series No. Subplate Mounting, DC 24V Transistor Sensing Switch	Pres. Adj. Range (Bar) 50K: 6~50 100K: 15~100 200K: 30~200 280K: 40~280 400K: 50~400	Design No: 21B: 1/4" PT 21B80: 1/4" PF(G) 21B90: 1/4" NPT

※DIMENSION

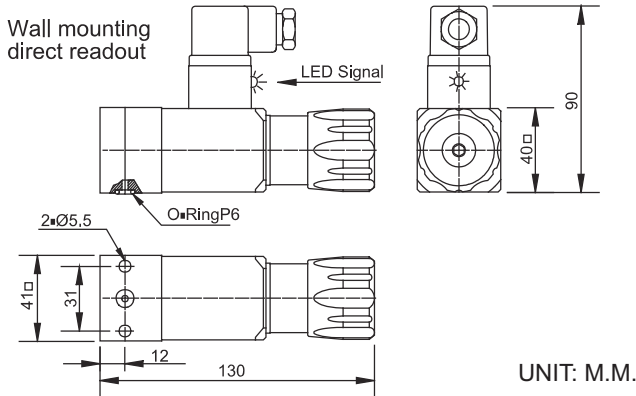

※WIRING DIAGRAM

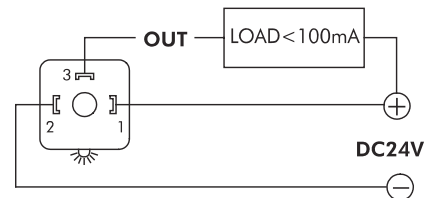

Breaking Capacity	Voltage Up To	Resistance Load
D.C.	24V	<100 mA
Electrically: 80,000,000 Times		

※PERFORMANCE CURVE

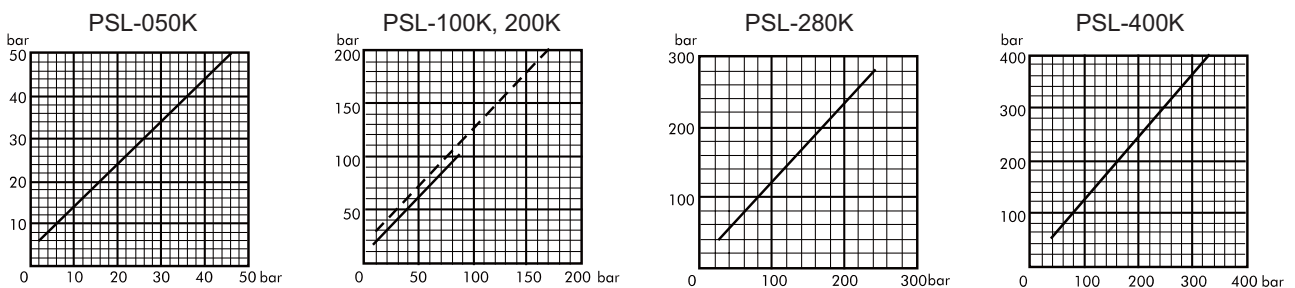

※SCHEMATIC CROSS-SECTION

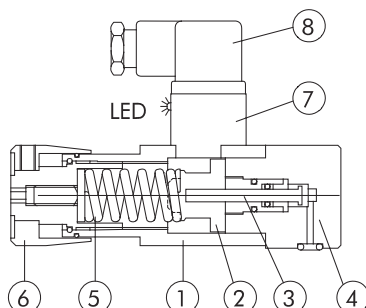

1	Body(Aluminum Alloy)	5	Spring
2	Switch Sensing Seat	6	Pressure Adj, Knob
3	Servo Piston	7	Induction-Switch
4	Connection Part	8	Wiring Connector

[PYC]

※SPECIFICATION

MODEL	PRES. ADJ. RANGE (Bar)	SURGE PRES. (Bar)	WEIGHT (Kg)
PYC-210K	10~210	280	1.8

※MODEL NUMBER DESIGNATION

PYC	210K	21B
Series No. Pilot Pressure Relief Type Switch	Pres. Adj. Range (Bar) 210K: 10~210	Design No: 21B: 1/4" PT 21B80: 1/4" PF(G) 21B90: 1/4" NPT



※DIMENSION

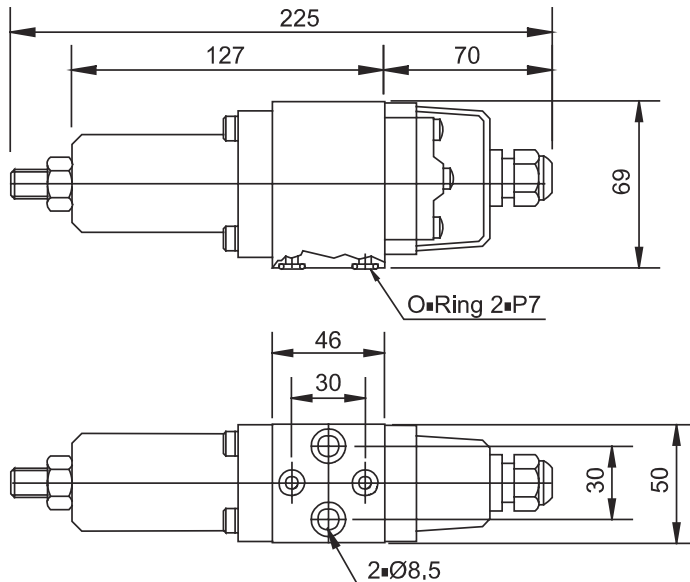

※PERFORMANCE CURVE

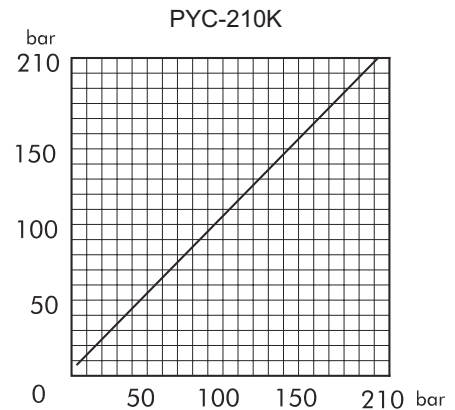

Breaking Capacity	Voltage Up To	Resistance Load
A.C.	125/250/480	15 A
D.C.	125	0.5A
	250	0.25A

Life Time: 200,000 Times

UNIT: M.M.

※SCHEMATIC CROSS-SECTION

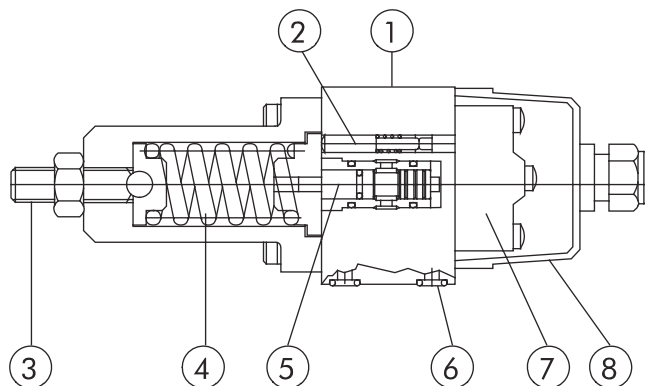

1	Body(Aluminum Alloy)	5	Servo Piston
2	Micro Switch Guide	6	O-Ring-P7
3	Pressure Adj. Screw	7	Micro-Switch
4	Spring	8	Cover

[DNP]

※SPECIFICATION

MODEL	PRES. ADJ. RANGE (Bar)	SURGE PRES. (Bar)	WEIGHT (Kg)
DNP-02K	0.3~2	80	0.2
DNP-08K	0.6~8		
DNP-20K	1.5~20		



※MODEL NUMBER DESIGNATION

DNP	02K	21B
Series No. Low Pressure Diaphragm Type	Pres. Adj. Range (Bar) 02K: 0.3~2 08K: 0.6~8 20K: 1.5~20	Design No: 21B: 1/4" PT 21B80: 1/4" PF(G) 21B90: 1/4" NPT

※DIMENSION

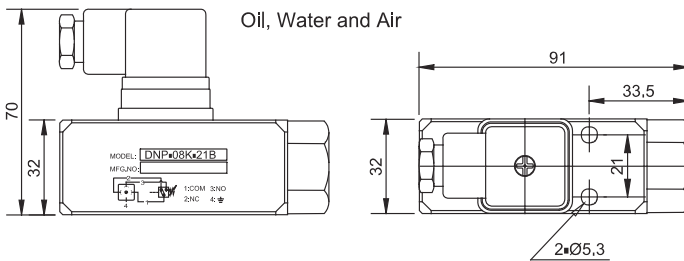

UNIT: M.M.

※GRAPHIC SYMBOL

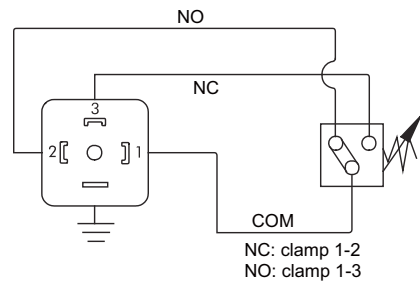

Breaking Capacity	Voltage Up To	Resistance Load
A.C.	125/250 V	5 A
D.C.	30 V	5 A
	125 V	0.15 A

Life Time: 100,000 Times

※PERFORMANCE CURVE

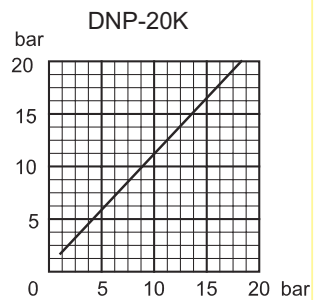
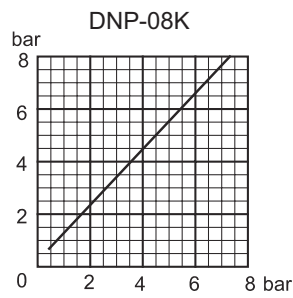
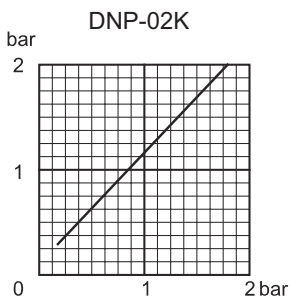

※SCHEMATIC CROSS-SECTION

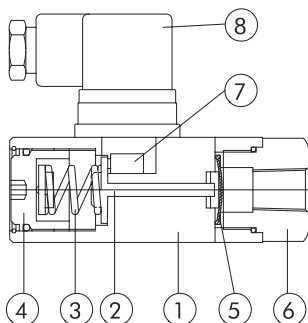

1	Body(Aluminum Alloy)	5	Diaphragm
2	Servo Piston	6	Connection Port
3	Spring	7	Micro-Switch
4	Pressure Adj. Knob	8	Wiring Connector

[DNMB]

※SPECIFICATION

MODEL	SURGE PRESSURE(Bar)				WEIGHT (Kg)
	40K	070K	150K	250K	
DNMB-02-A/B/P	200	200	350	350	5.5
DNMB-02-W					0.8
DNMB-03-A/B/P					0.75
DNMB-03-W					1.0

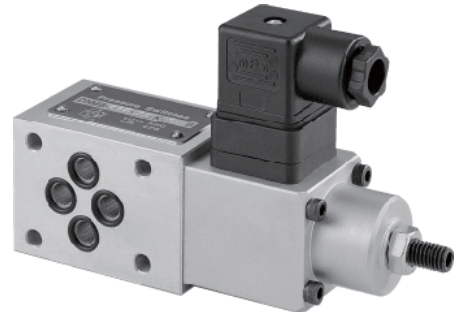

※MODEL NUMBER DESIGNATION

DNMB	02	P	150K	21B
Series No. Modular(Stack) Type	Valve Size 02: 1/4"(NG6) 03: 3/8"(NG10)	Function Port P: "P" Port A: "A" Port B: "B" Port W: "A"&"B" Port	Pres. Adj. Range (Bar) 40K: 5~40 70K: 6~70 150K: 30~150 250K: 40~250	Design No: 21B: 1/4" PT 21B80: 1/4" PF(G) 21B90: 1/4" NPT

※SYMBOL

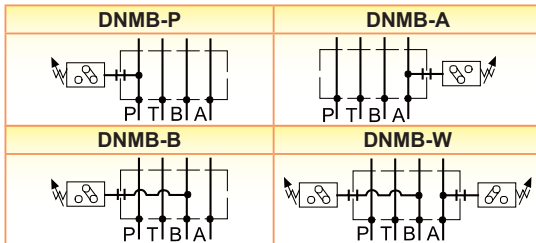

※GRAPHIC SYMBOL

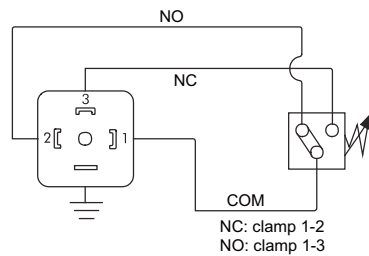

Breaking Capacity	Voltage Up To	Resistance Load
A.C.	125/250 V	5 A
D.C.	30 V	5 A
	125 V	0.15 A

Life Time: 100,000 Times

※PERFORMANCE CURVE

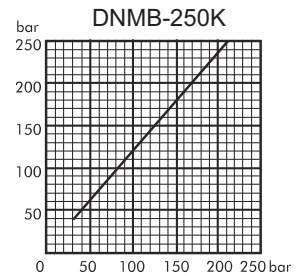
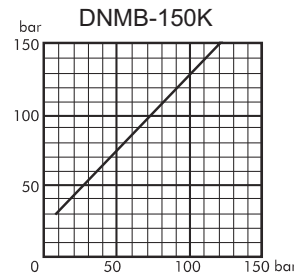
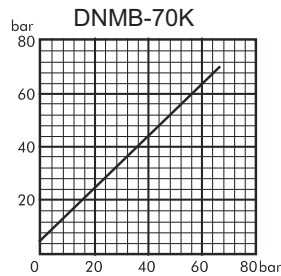
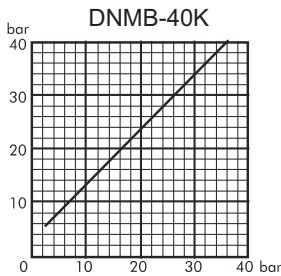

※DIMENSIONS

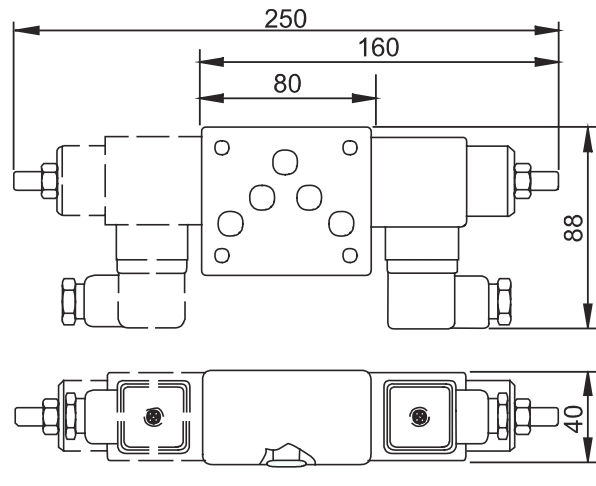
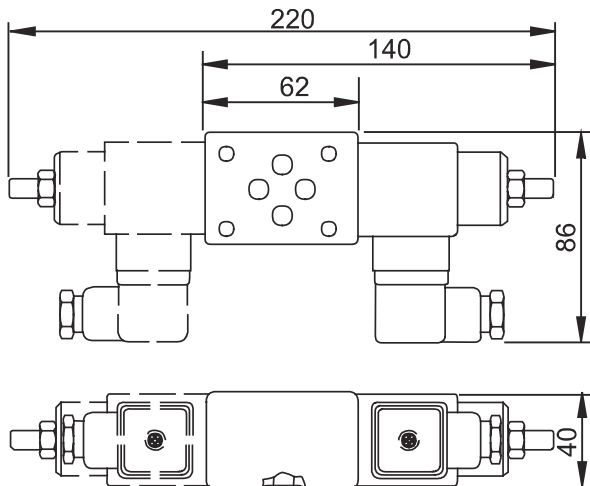

UNIT: M.M.

[DNA]

※SPECIFICATION

MODEL	PRES. ADJ. RANGE (Bar)	SURGE PRES. (Bar)	WEIGHT (Kg)
DNA-40KK	6~40	150	1.0
DNA-100K	15~100	250	
DNA-250K	40~250	300	
DNA-360K	50~360	400	



※MODEL NUMBER DESIGNATION

DNA	40K	22B
Series No. Direct Read-Out, Standard Type	Pres. Adj. Range (Bar) 40K: 6~40 100K: 15~100 250K: 40~250 360K: 50~360	Design No: 22B: 1/4" PT 22B80: 1/4" PF(G) 22B90: 1/4" NPT

※DIMENSION

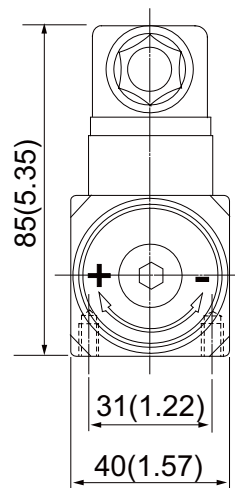
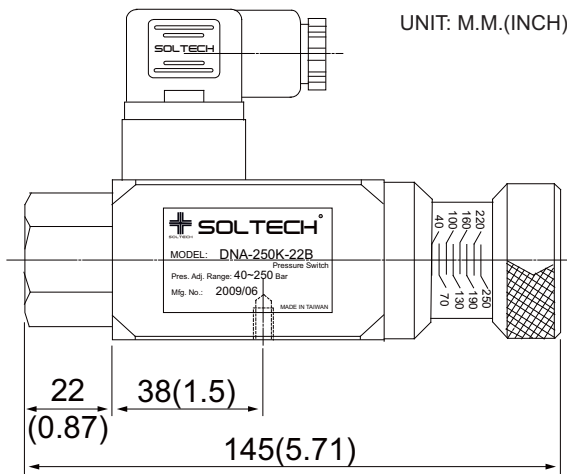

※GRAPHIC SYMBOL

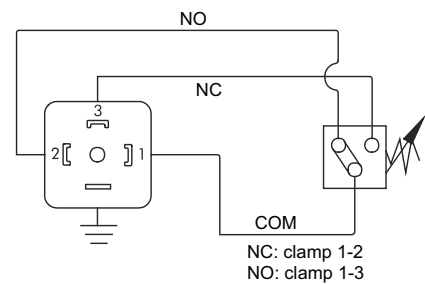

Breaking Capacity	Voltage Up To	Resistance Load
A.C.	125/250 V	5 A
D.C.	30 V	5 A
	125 V	0.15 A

Life Time: 100,000 Times

※PERFORMANCE CURVE

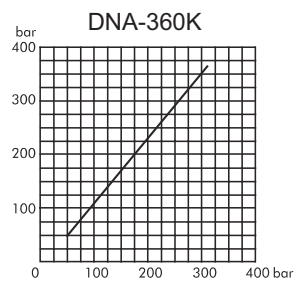
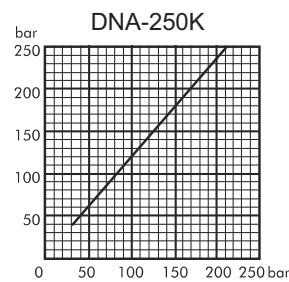
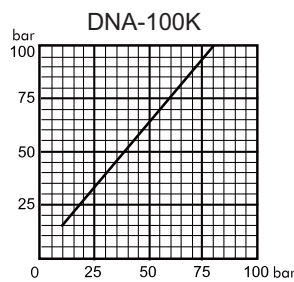
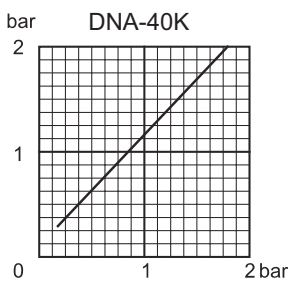

※SCHEMATIC CROSS-SECTION

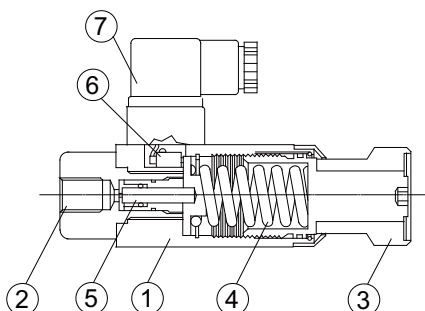

1	Body(Casting Iron)	5	Servo Piston
2	Connecting Port	6	Micro-Switch
3	Pressure Adj, Knob	7	Wiring Connector
4	Spring		

[DNB]

※SPECIFICATION

MODEL	PRES. ADJ. RANGE (Bar)	SURGE PRES. (Bar)	WEIGHT (Kg)
DNB-40K	5~40	150	0.6
DNB-70K	6~70	200	
DNB-150K	30~150	300	
DNB-250K	40~250	400	



※MODEL NUMBER DESIGNATION

DNB	40K	22B
Series No.	Pres. Adj. Range (Bar)	Design No:
General Type	40K: 5~40 70K: 6~70 150K: 30~150 250K: 40~250	22B: 1/4" PT 22B80: 1/4" PF(G) 22B90: 1/4" NPT

※DIMENSION

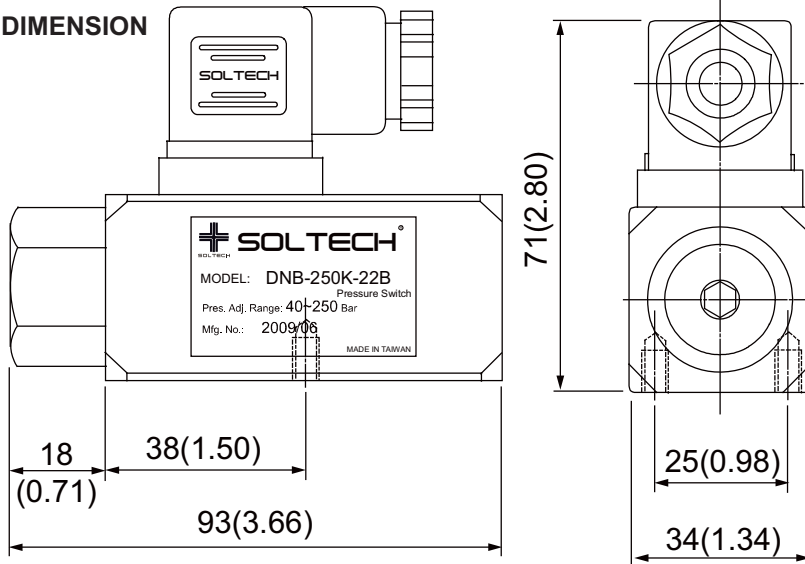

※GRAPHIC SYMBOL

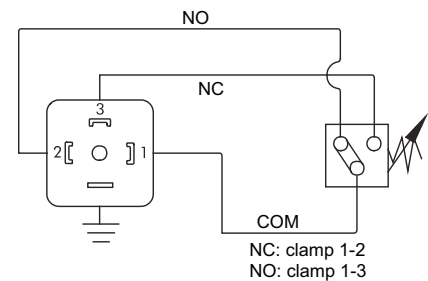

Breaking Capacity	Voltage Up To	Resistance Load
A.C.	125/250 V	5 A
D.C.	30 V	5 A
	125 V	0.15 A

Life Time: 100,000 Times

UNIT: M.M.(INCH)

※PERFORMANCE CURVE

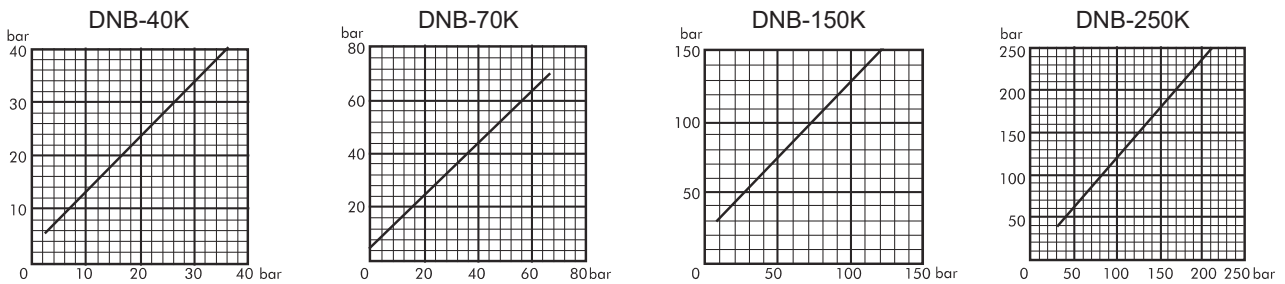

※SCHEMATIC CROSS-SECTION

1	Body(Casting Iron)	5	Servo Piston
2	Connecting Port	6	Micro-Switch
3	Pressure Adj. Knob	7	Wiring Connector
4	Spring		

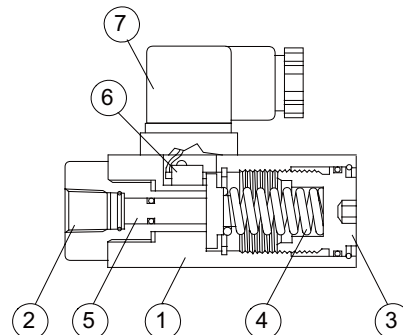

[DNC]

※SPECIFICATION

MODEL	PRES. ADJ. RANGE (Bar)	SURGE PRES. (Bar)	WEIGHT (Kg)
DNC-40K	6~40	150	1.0
DNC-100K	15~100	250	
DNC-250K	40~250	300	
DNC-360K	50~360	400	

※MODEL NUMBER DESIGNATION

DNC	40K	22B
Series No. Cartridge Mounting Direct Read-Out Type	Pres. Adj. Range (Bar) 40K: 6~40 100K: 15~100 250K: 40~250 360K: 50~360	Design No: 22B: 1/4" PT 22B80: 1/4" PF(G) 22B90: 1/4" NPT



※DIMENSION

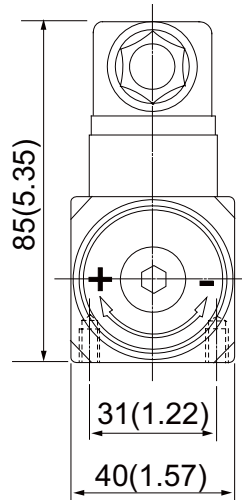
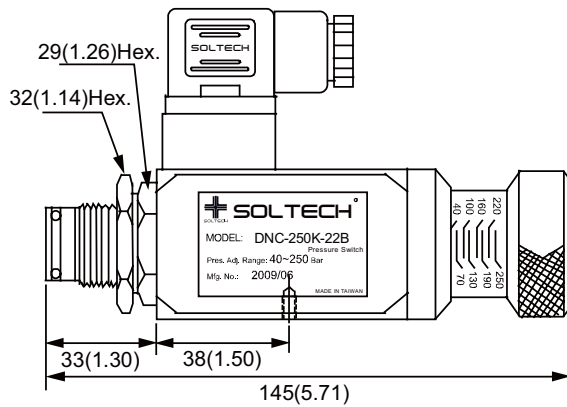

※GRAPHIC SYMBOL

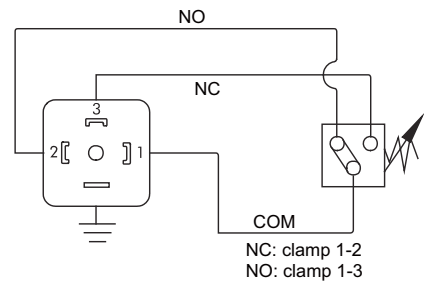

Breaking Capacity	Voltage Up To	Resistance Load
A.C.	125/250 V	5 A
D.C.	30 V	5 A
	125 V	0.15 A

Life Time: 100,000 Times

※PERFORMANCE CURVE

UNIT: M.M.(INCH)

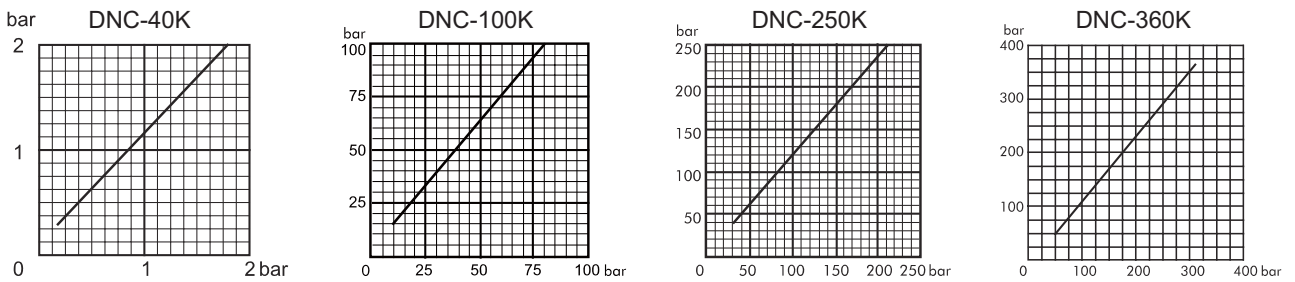

※SCHEMATIC CROSS-SECTION

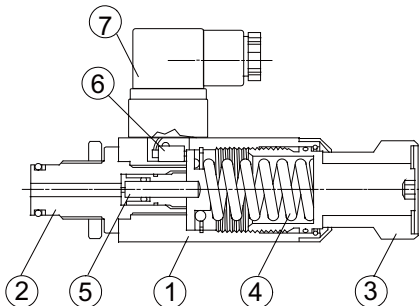

1	Body(Casting Iron)	5	Servo Piston
2	Connecting Port	6	Micro-Switch
3	Pressure Adj. Knob	7	Wiring Connector
4	Spring		

※CAVITY

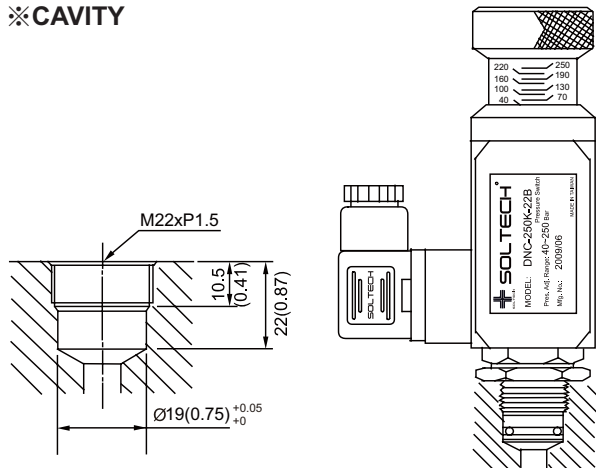

[DNF]

※SPECIFICATION

MODEL	PRES. ADJ. RANGE (Bar)	SURGE PRES. (Bar)	WEIGHT (Kg)
DNF-40KK	6~40	150	1.2
DNF-100K	15~100	250	
DNF-250K	40~250	300	
DNF-360K	50~360	400	

※MODEL NUMBER DESIGNATION

DNF	40K	22B
Series No. Panel Mounting Direct Read-Out Type	Pres. Adj. Range (Bar) 40K: 6~40 100K: 15~100 250K: 40~250 360K: 50~360	Design No: 22B: 1/4" PT 22B80: 1/4" PF(G) 22B90: 1/4" NPT



※DIMENSION

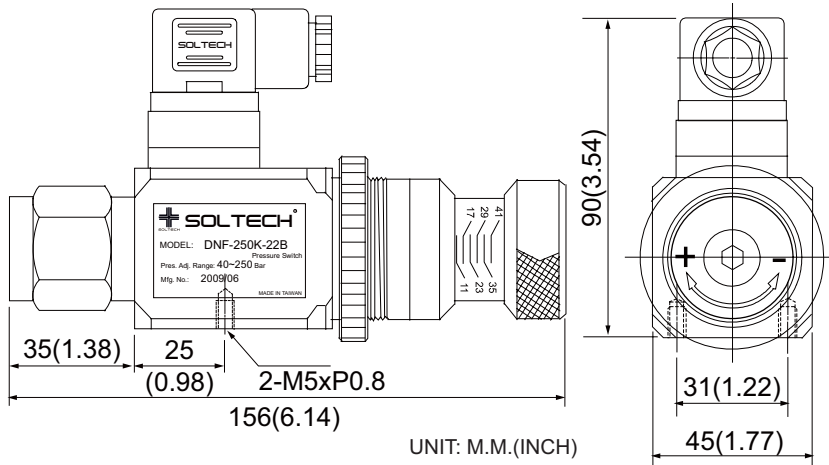

※GRAPHIC SYMBOL

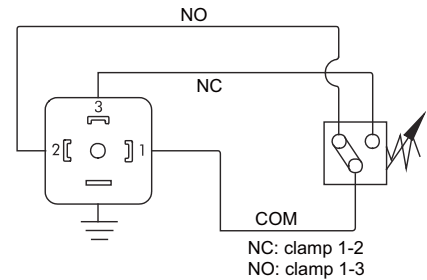

Breaking Capacity	Voltage Up To	Resistance Load
A.C.	125/250 V	5 A
D.C.	30 V	5 A
	125 V	0.15 A

Life Time: 100,000 Times

※PERFORMANCE CURVE

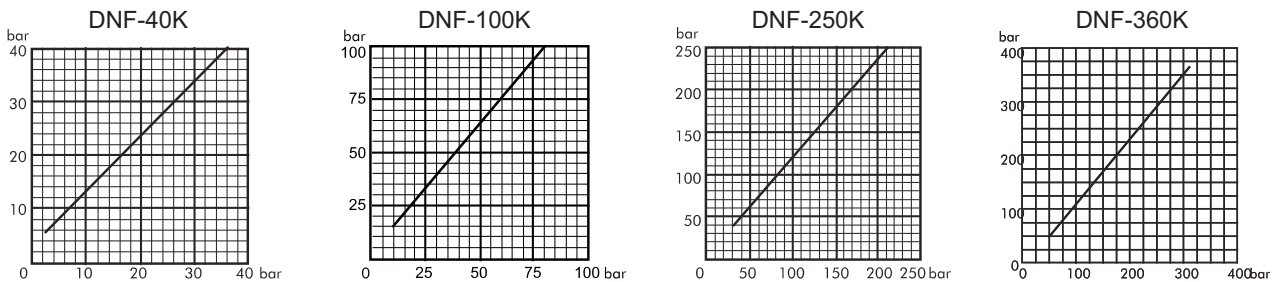

※SCHEMATIC CROSS-SECTION

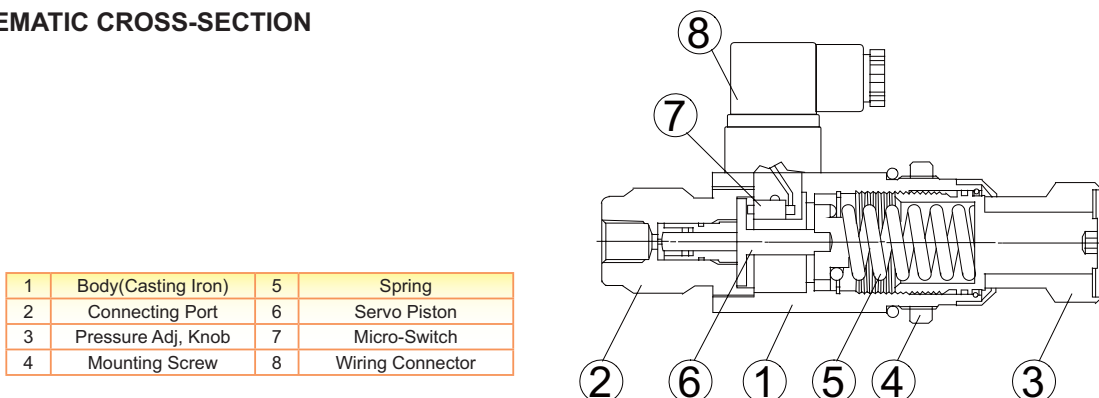

[DNL]

※SPECIFICATION

MODEL	PRES. ADJ. RANGE (Bar)	SURGE PRES. (Bar)	WEIGHT (Kg)
DNL-50K	6~50	200	1.0
DNL-100K	15~100	300	
DNL-200K	30~200	300	
DNL-280K	40~280	350	
DNLL-400K	50~400	450	

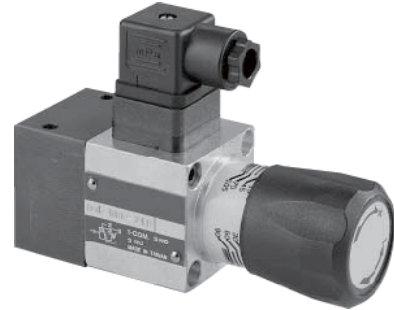

※MODEL NUMBER DESIGNATION

DNL	280K	21B
Series No. Direct Read-Out, Heavy Duty Type	Pres. Adj. Range (Bar) 50K: 6~50 100K: 15~100 200K: 30~200 280K: 40~280 400K: 50~400	Design No: 21B: 1/4" PT 21B80: 1/4" PF(G) 21B90: 1/4" NPT

※DIMENSION

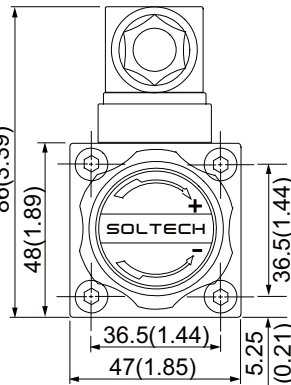
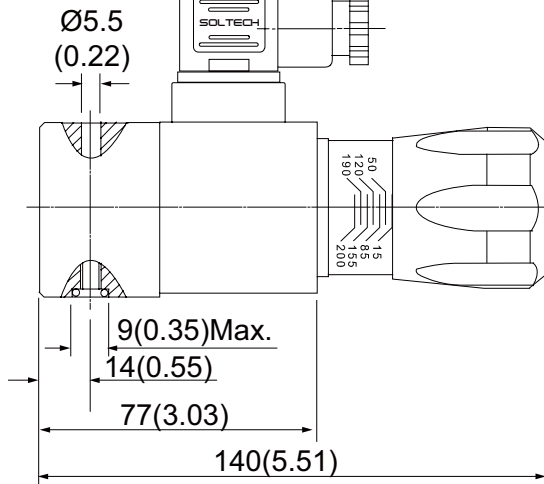

※GRAPHIC SYMBOL

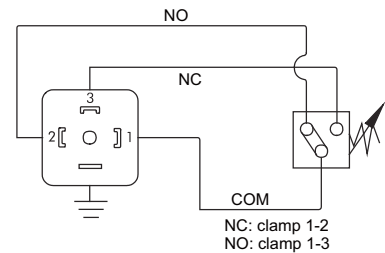

Breaking Capacity	Voltage Up To	Resistance Load
A.C.	125/250 V	10 A
D.C.	125 V	0.3 A
	250 V	0.15 A

Life Time: 200,000 Times

※PERFORMANCE CURVE

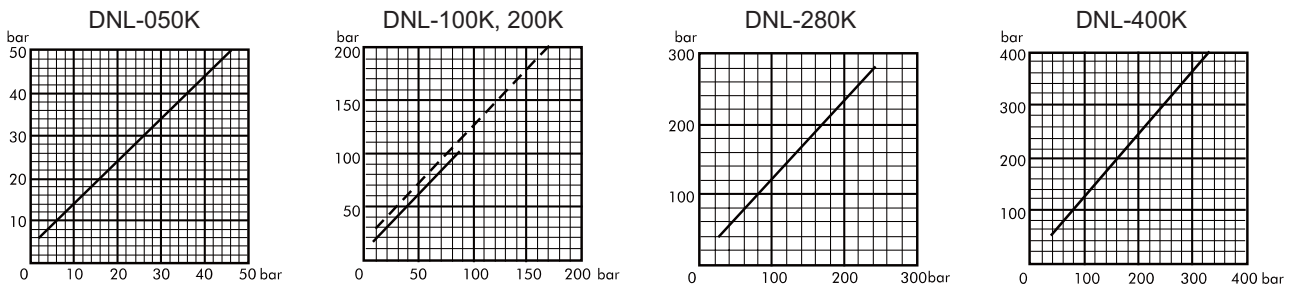

UNIT: M.M.(INCH)

※SCHEMATIC CROSS-SECTION

1	Body(Aluminum Alloy)	5	Servo Piston
2	Connection Port	6	Micro Switch
3	Pressure Adj. Knob	7	Wiring Connector
4	Spring	8	O-Ring P6(M5P×0.8)

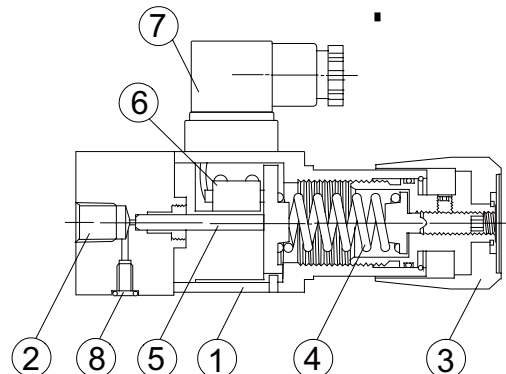

[DNM]

※SPECIFICATION

MODEL	SURGE PRESSURE(Bar)			WEIGHT (Kg)
	40K	10K	250K	
DNM-02-A/B/P	150	250	300	2.1
DNM-02-W				3.1
DNM-03-A/B/P				3.1
DNM-03-W				4.1

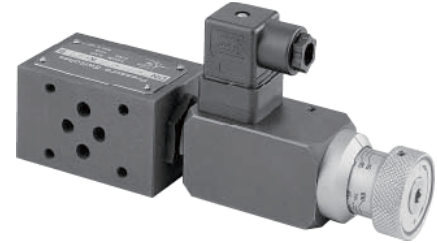

※MODEL NUMBER DESIGNATION

DNM	02	P	100K	21B
Series No. Modular(Stack) Type	Valve Size 02: 1/4"(NG6) 03: 3/8"(NG10)	Function Port P: "P" Port A: "A" Port B: "B" Port W: "A"&"B" Port	Pres. Adj. Range (Bar) 40K: 6~40 100K: 15~100 250K: 40~250	Design No: 21B: 1/4" PT 21B80: 1/4" PF(G) 21B90: 1/4" NPT

※SYMBOL

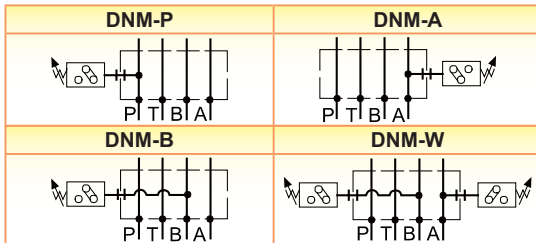

※GRAPHIC SYMBOL

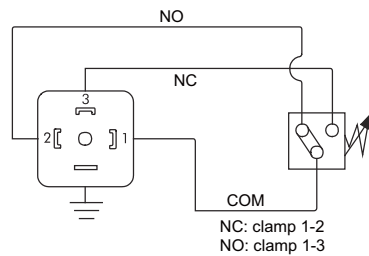

Breaking Capacity	Voltage Up To	Resistance Load
A.C.	125/250 V	5 A
D.C.	30 V	5 A
	125 V	0.15 A

Life Time: 100,000 Times

※PERFORMANCE CURVE

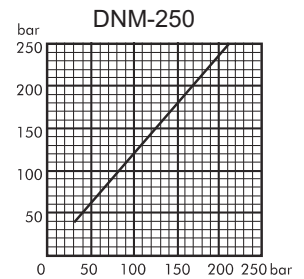
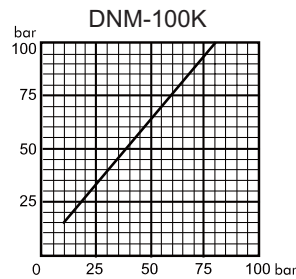
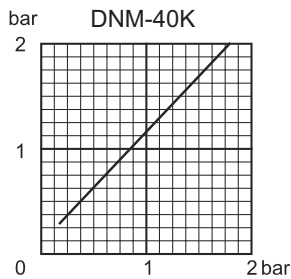

※DIMENSIONS

DNM-02

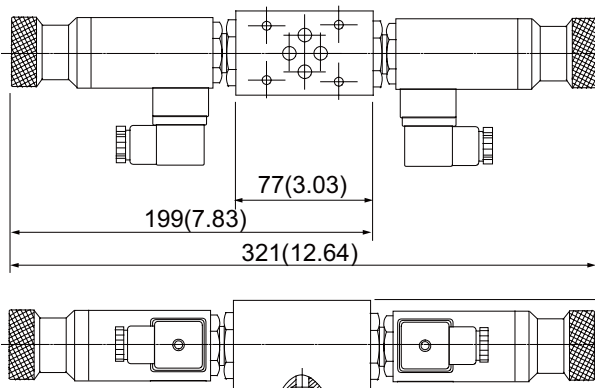

DNM-03

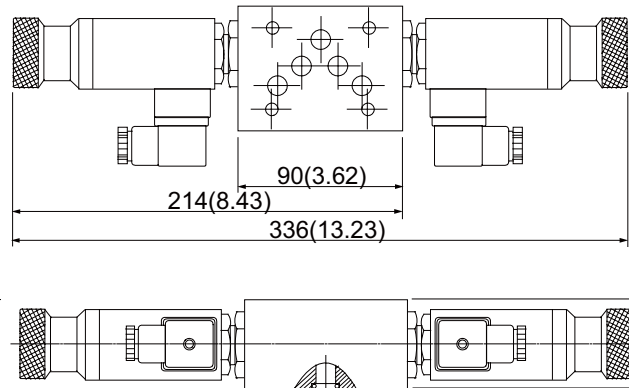

UNIT: M.M.(INCH)

[ASSEMBLY]

DNA

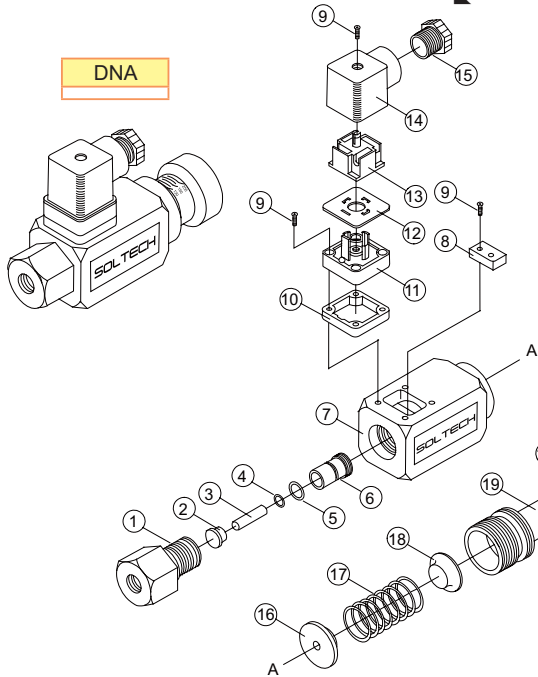

1. Pipe Connector	12. Gasket
2. Packing Gasket	13. Terminal Block
3. Servo-Piston	14. Housing
4. Packing	15. Gland-Nut
5. Back-Ring	16. Mechanical Stop
6. Piston Cover	17. Spring
7. Body	18. Spring Retainer
8. Micro-Switch	19. Pressure Adj. Screw
9. Fixing Screw	20. Control Knob Set Screw
10. Electric Connector Gasket	21. Control Knob
11. Electric Connector Base	22. Nameplate

DNB

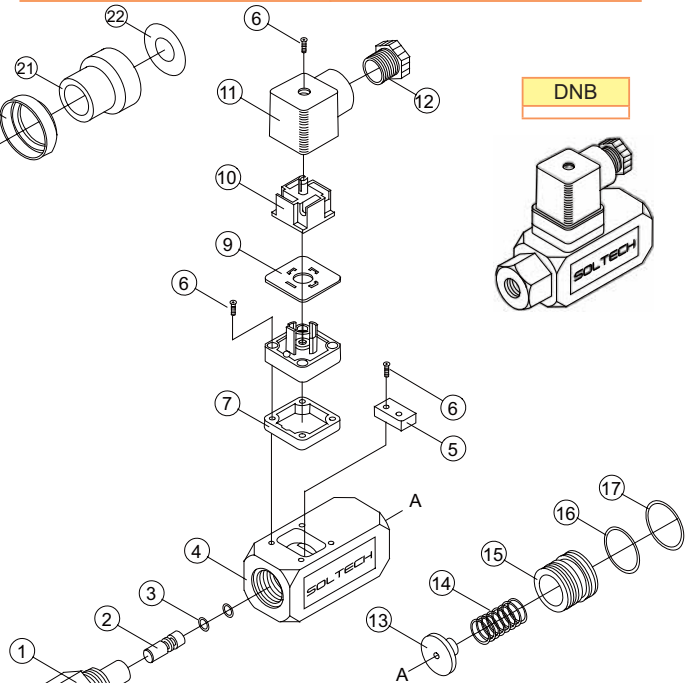

1. Pipe Connector	9. Gasket
2. Servo-Piston	10. Terminal Block
3. O-Ring	11. Housing
4. Body	12. Gland-Nut
5. Micro-Switch	13. Mechanical Stop
6. Fixing Screw	14. Spring
7. Electric Connector Gasket	15. Pressure Adj. Screw
8. Electric Connector Base	16. O-Ring
	17. O-Ring

DNF

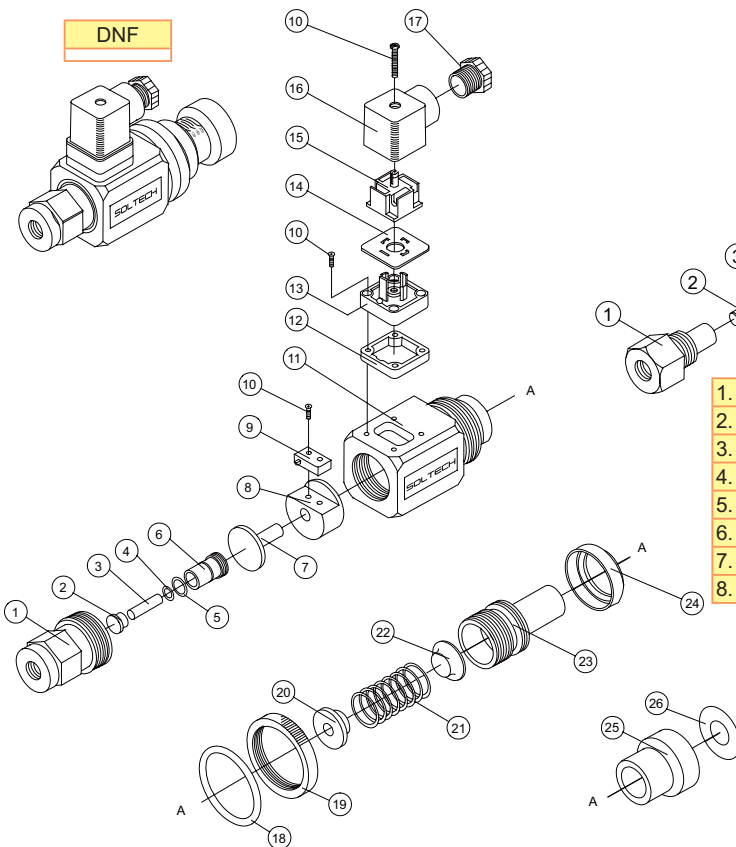

1. Pipe Connector	7. Pressure Actuator	13. Electric Connector Base	20. Mechanical Stop
2. Packing Gasket	8. Micro-Switch Seat	14. Gasket	21. Spring
3. Servo-Piston	9. Micro-Switch	15. Terminal Block	22. Spring Retainer
4. Packing	10. Fixing Screw	16. Housing	23. Pressure Adj. Screw
5. Back-Ring	11. Body	17. Gland-Nut	24. Control Knob Set Screw
6. Piston Cover	12. Electric Connector Gasket	18. O-Ring	25. Control Knob
		19. Screw-Nut	26. Nameplate